

DIGITAL TWIN FOR EDUCATION

software requirements and examples of digital twins

Module 1

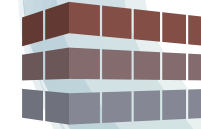

CARL-BENZ-SCHULE
GAGGENAU



Mercantec



Co-funded by
the European Union

DISCLAIMER



**Co-funded by
the European Union**

Funded by the European Union. Views and opinions expressed are however those of the author(s) only and do not necessarily reflect those of the European Union or the European Education and Culture Executive Agency (EACEA). Neither the European Union nor EACEA can be held responsible for them.



Software requirements



Simulation Tool PLC SIM Adv.

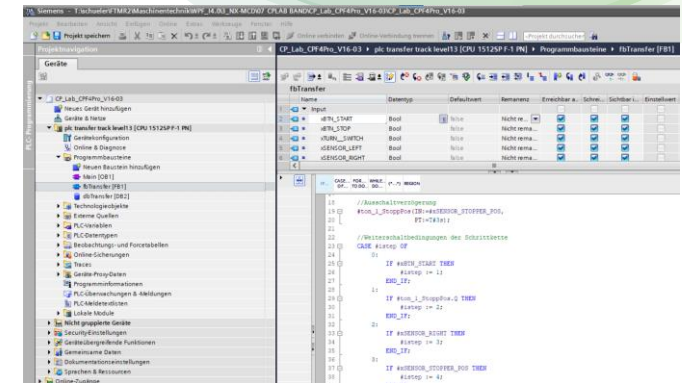
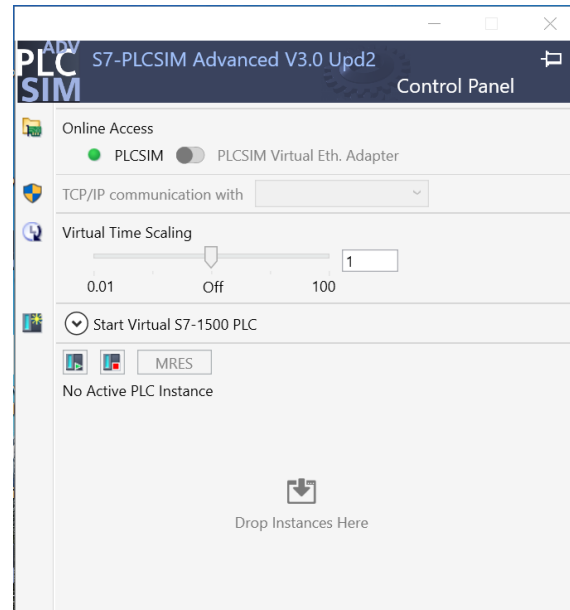

PLC Programming Software Siemens TIA-Portal

Simulation Software Siemens NX MCD

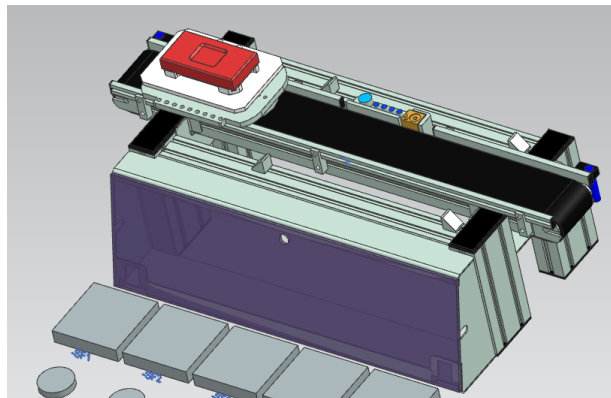

Creating a Soft-PLC as a
connector between
MCD and TIA Portal



Examples of digital twins

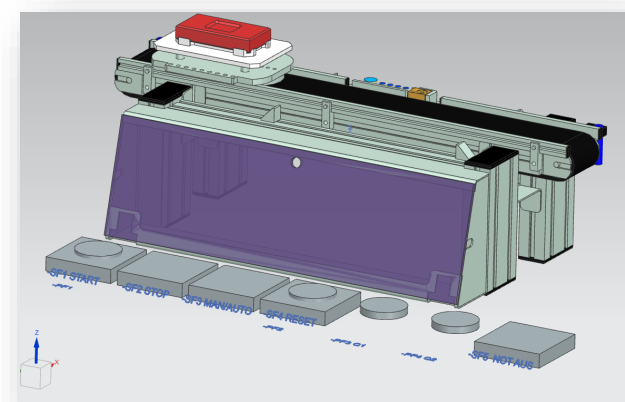
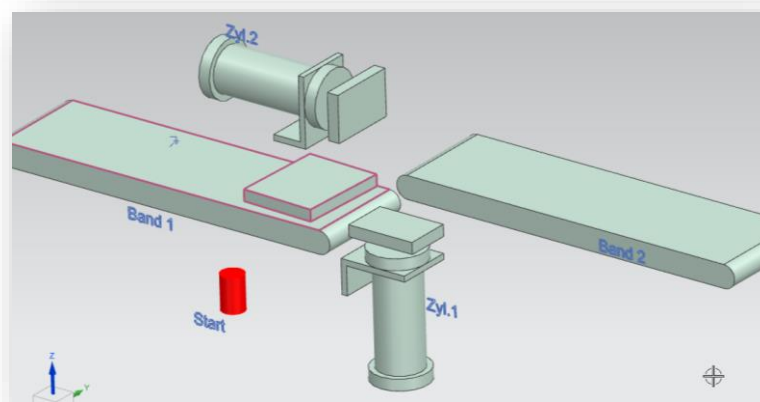
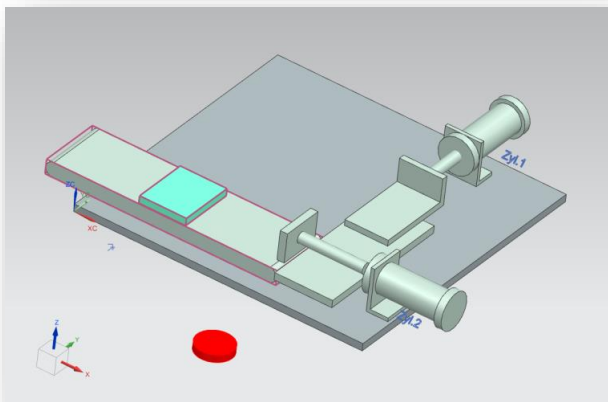
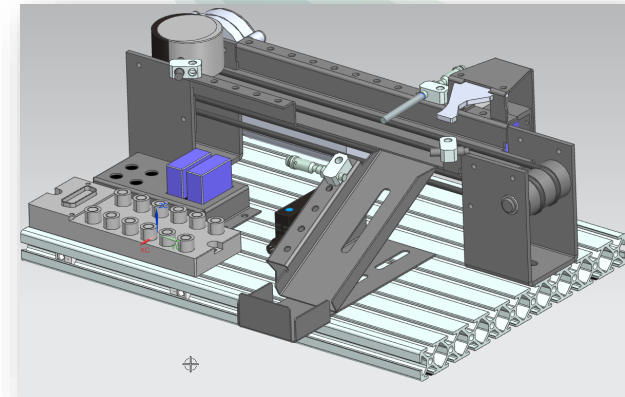
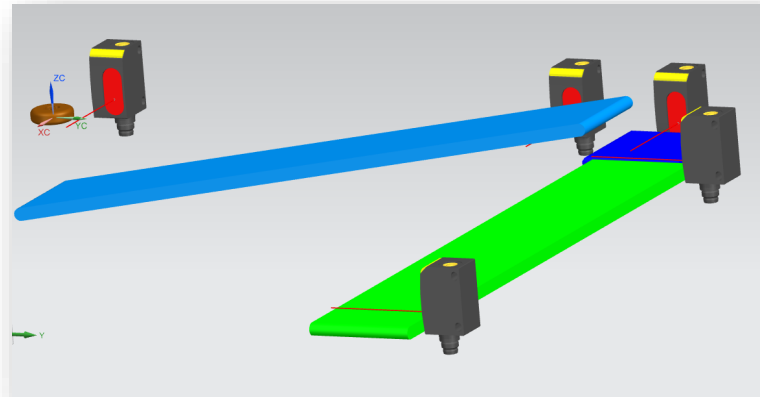
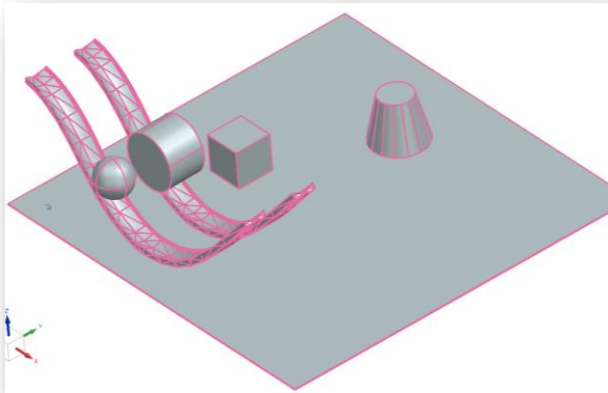

Examples of digital twins

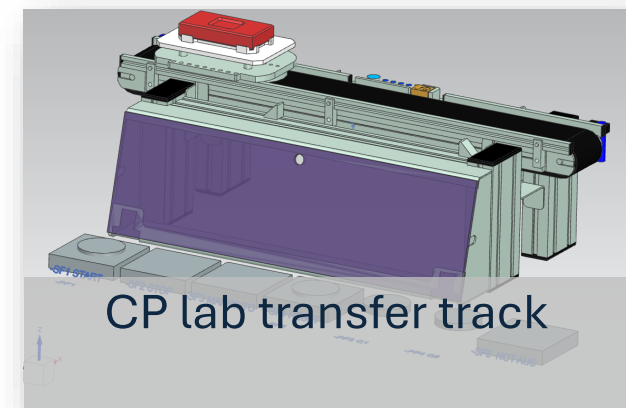
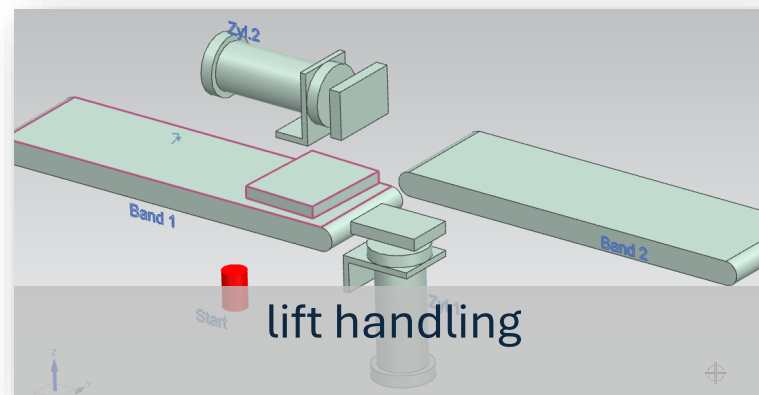
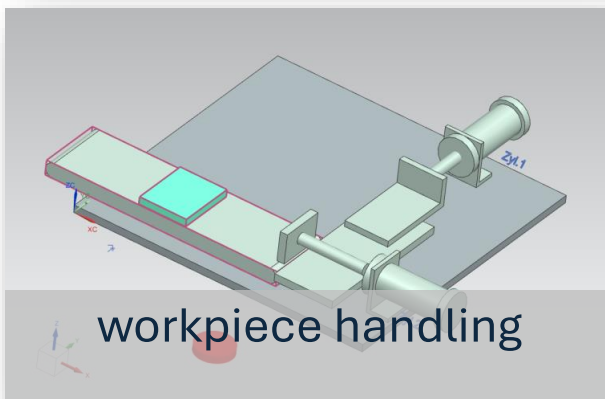
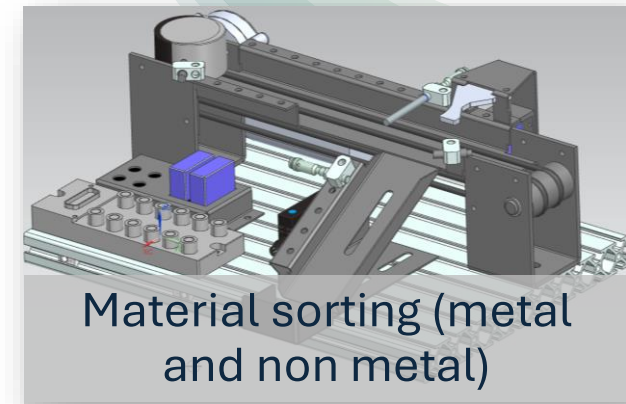
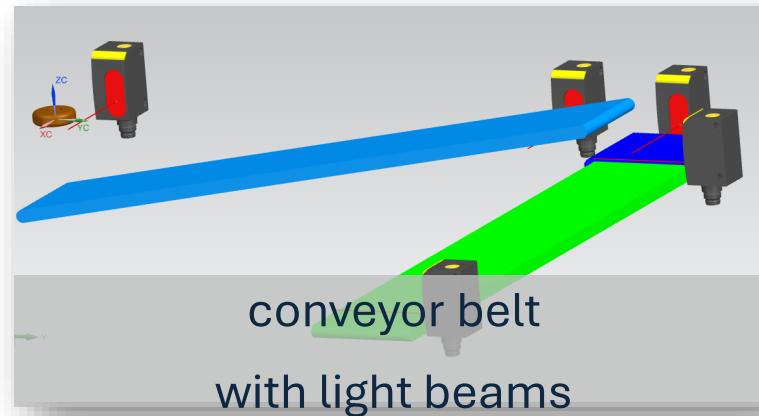
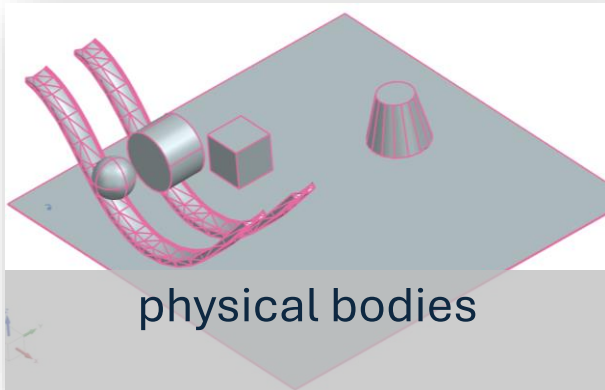

Physical bodies

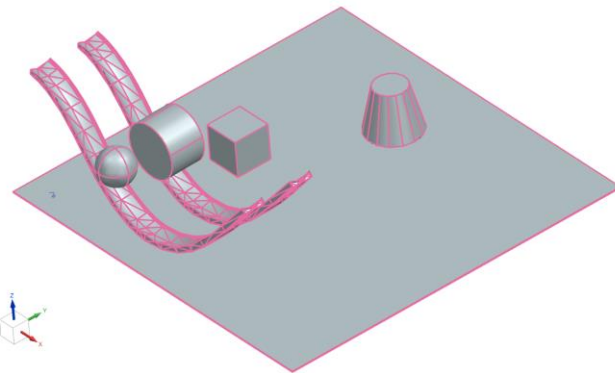
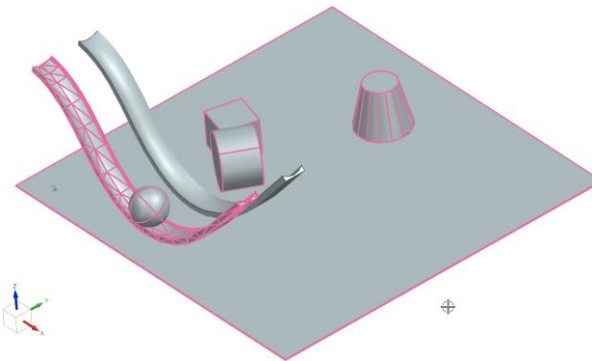
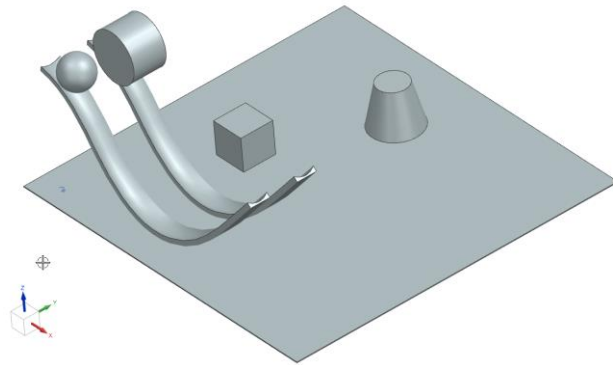

The digital models can be given physical properties (e.g. density, friction, ...). Thus, the model behavior corresponds to the real behavior. The bodies roll down the ramp at different speeds. Also bodies can leave the ramp.

Conveyor belt with light beams

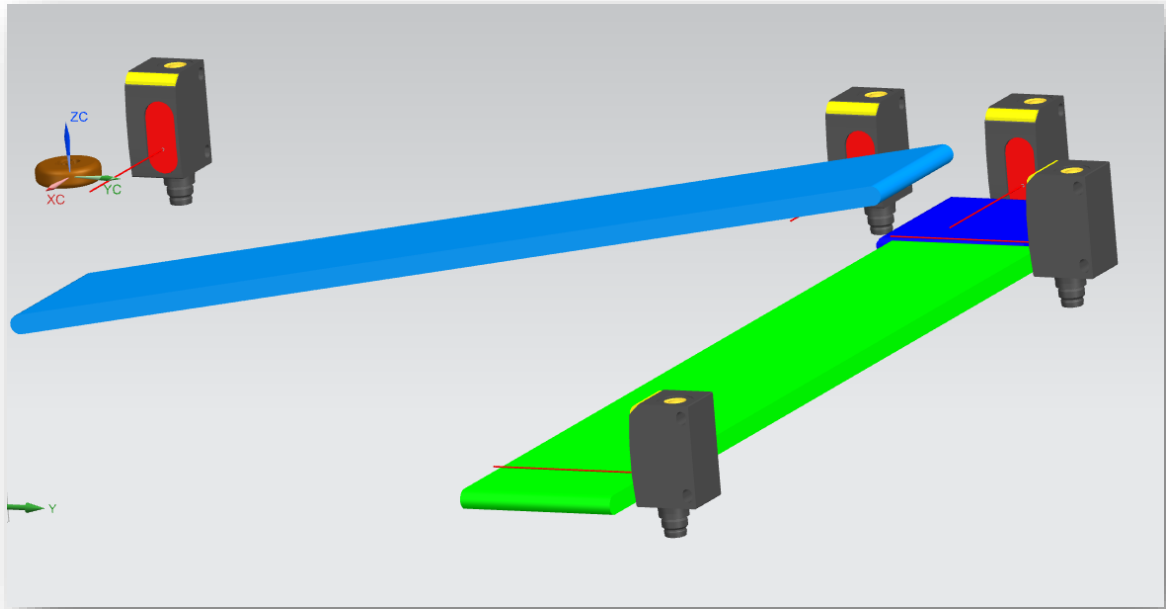

Different bodies can be transported on the belt. Modelled light barriers give signals (e.g. to a controller) that can be further processed.

Workpiece handling

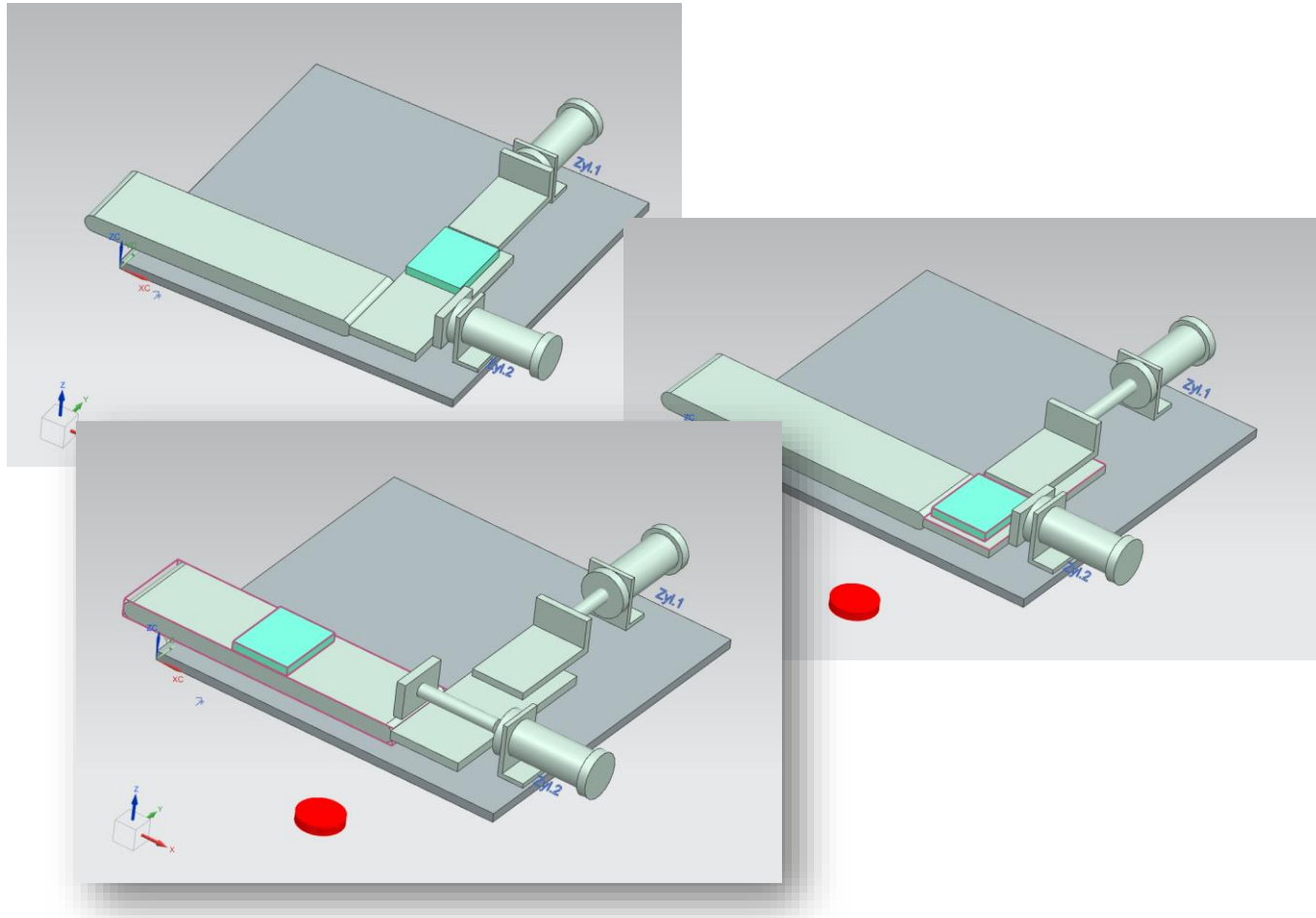

Digital pneumatic cylinders extend and transmit a force to the workpieces so that they reach the next conveyor belt. The cylinders can be integrated into PLC programming and controlled.

Lift handling

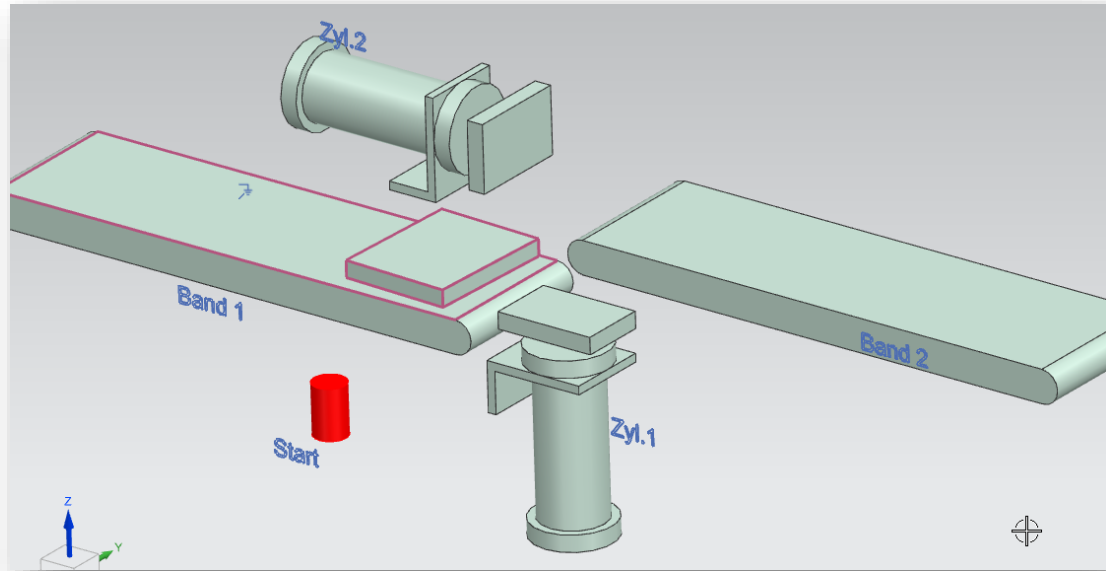

Similarly, a vertical production line can also be simulated using the physical properties. In this example, one cylinder is used as a lifting cylinder and the other as an extension cylinder. Both are controlled by a PLC.

Sorting station

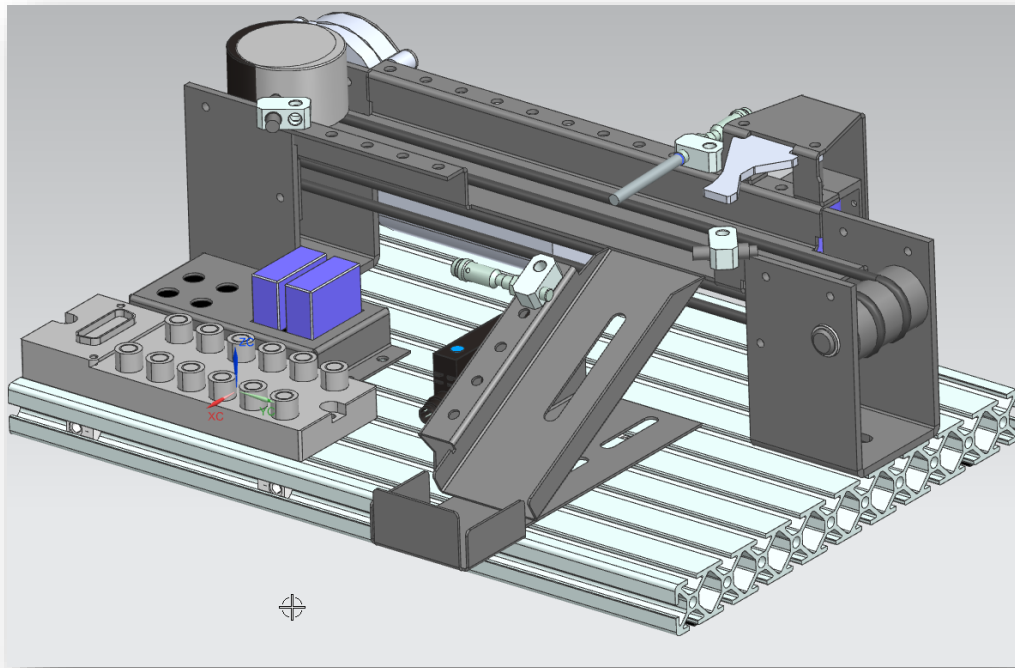

In the material sorting system, a distinction is made between metallic and non-metallic workpieces. The material properties are given to the workpieces as part of the creation of a digital twin. The system can sort out metallic or non-metallic workpieces on the basis of PLC programming.

CP Lab transfer track

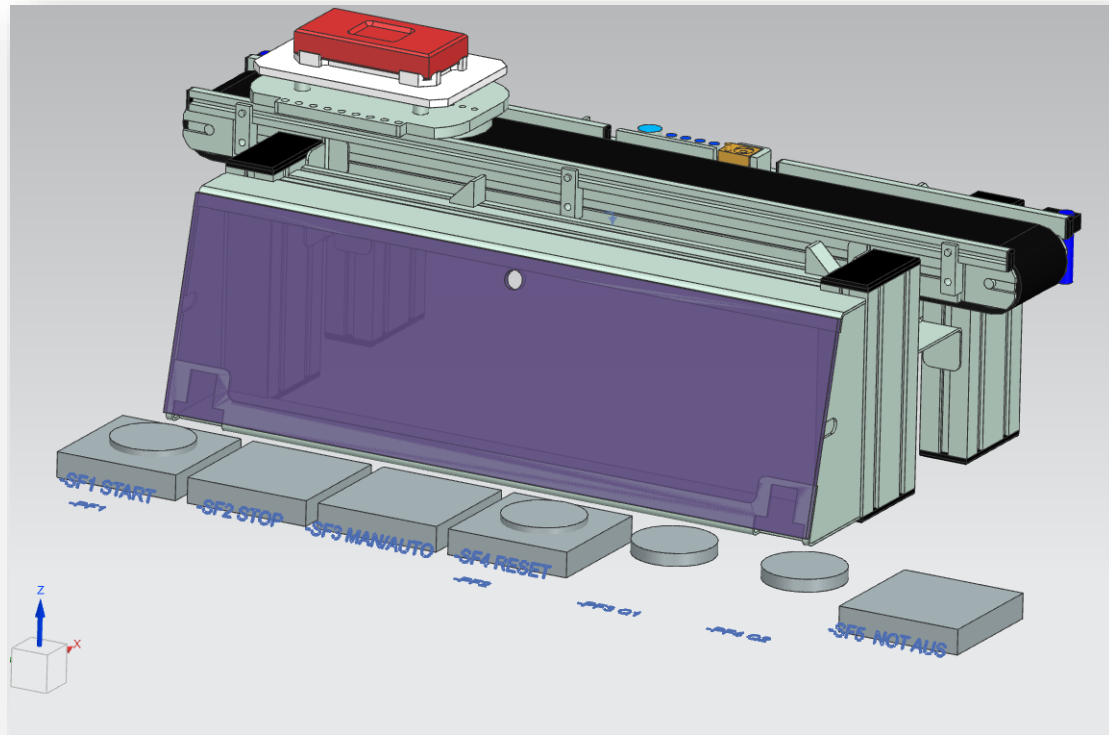

Here you can see the digital twin of the transfer track of a production plant. A workpiece (red) is transported through the production line on the belt with the help of a workpiece carrier. The transfer belt is controlled by a PLC. It has several sensors at the respective ends and in the middle. There is also a stopper in the middle. This allows the movements that are crucial for production to be realized.

CP Lab transfer with turning application

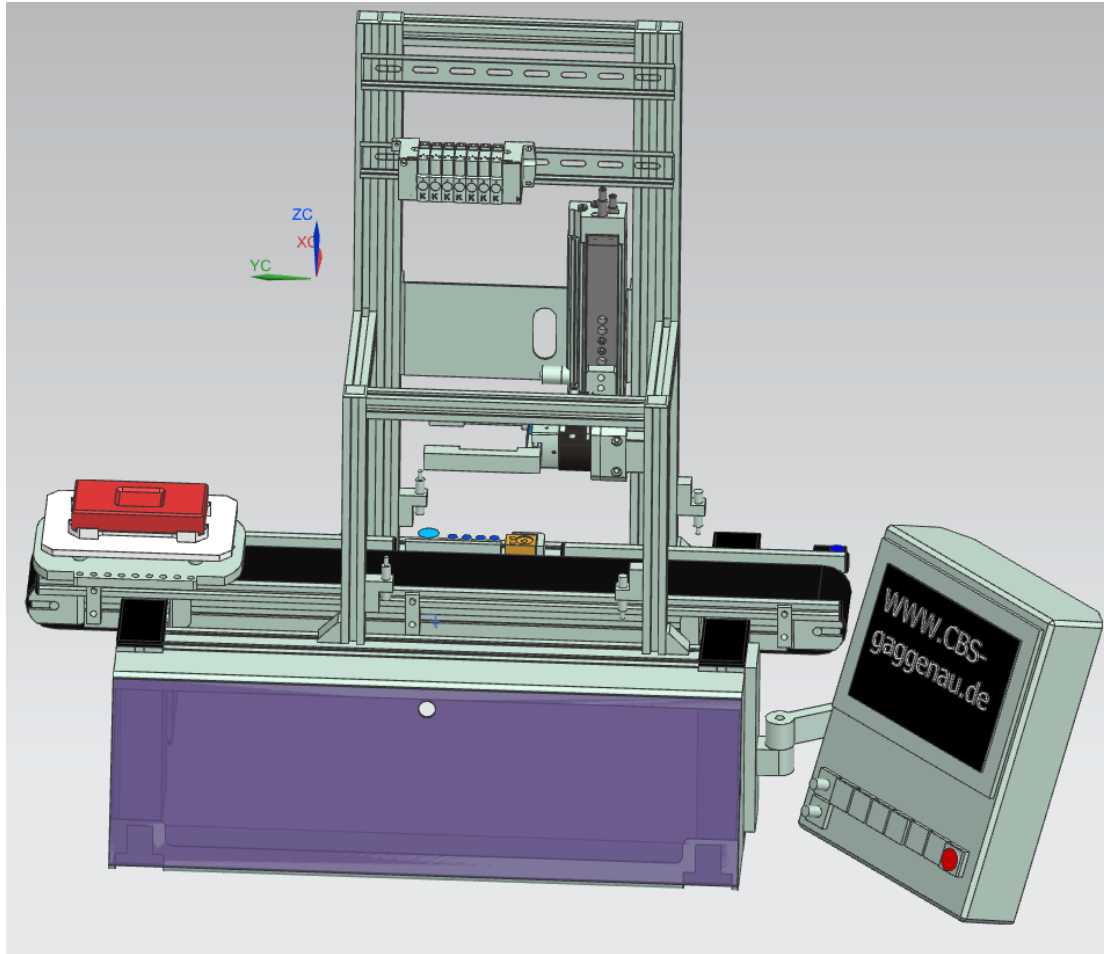

Here you can see the digital twin of the transfer track with the turning application on top.

This is the master piece of our digital twin. With this simulation tool a hole class can create plc programs in the same time and test their solutions directly.